

Ball Valve

DN 2" - 10"
ASME Class 150 - 900



INNO-BALL

Design

Split-body ball valve.
Trunnion mounted ball.
With soft seats or metal seats.
With full bore.
Actuator attachment acc. to DIN ISO 5211.

OPTIONAL GEAR OPERATOR

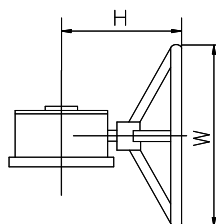

Dimensions (in mm)

Size DN	2"	3"	4"	6"	8"	10"
(Class 150) - L	178	203	229	394	457	533
(Class 300) - L	216	283	305	403	502	568
(Class 600) - L	292	356	432	559	660	787
(Class 900) - L	368	381	457	610	737	838
H1 (max)	175	207	237	305	359	415
H2 (max)	67	82	95	148	200	225
Lo (max)	450	600	1000	1000	1000	1000
(Class 150) - Weight (kg)	12	23	32	98	166	355
(Class 300) - Weight (kg)	15	31	46	110	170	400
(Class 600) - Weight (kg)	30	44	90	160	230	490
(Class 900) - Weight (kg)	50	85	140	350	560	810

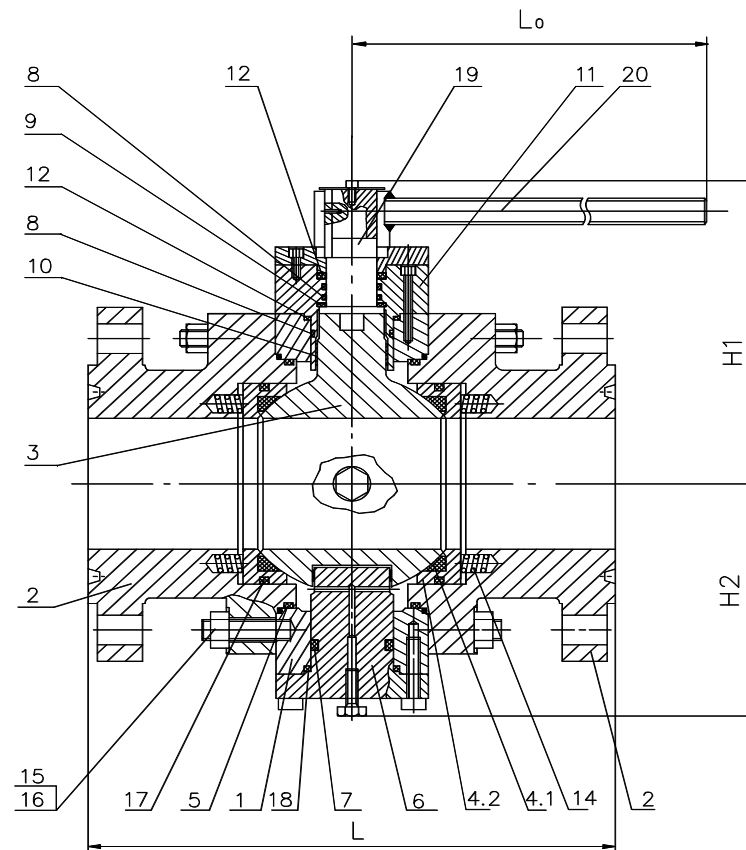

INNO-BALL

Material (DIN-Material on request)

Item	Part name	Carbon steel to ASTM Type A105 / WCB	Alloy steel to ASTM Type LF2 / LCB	Stainless steel to ASTM Type F316 / CF8M
1	Body	A105 / A216 WCB	A350 LF2 / A 352 LCB	A182 F316 / A351 CF8M
2	Body part	A105 / A216 WCB	A350 LF2 / A 352 LCB	A182 F316 / A351 CF8M
3	Ball	A351 CF8M / A105+ENP	A182 F316 / A351 CF8M	A182 F316 / A351 CF8M
4.1	Ball seat ring compl.	PTFE - Glass	PTFE - Glass	PTFE - Glass
4.2		A182 F316 Ti	A182 F316 Ti	A182 F316 Ti
5	Body gasket	Graphite / PTFE	Graphite / PTFE	Graphite / PTFE
6	Trunion	ENP A105+ENP	A350 LF2	A351 CF8M
7	Lower stem seal	Graphite / PTFE - Glass / Viton	Graphite / PTFE - Glass / Viton	Graphite / PTFE - Glass Viton
8	Upper stem seal	Graphite / PTFE	Graphite / PTFE	Graphite / PTFE
9	Bearing	PEEK	PEEK	PEEK
10	Lower and upper bearing	PTFE / A182 F316	PTFE / A182 F316	PTFE / A182 F316
11	Cover	A216 WCB / A105	A350 LF2	A182 F316 Ti
12	Cover gasket	Graphite / PTFE	Graphite / PTFE	Graphite / PTFE
13	Ring	A182 F316 Ti	A182 F51	A351 CF8M
14	Spring	17 - 7PH	Inconel	17 - 7PH / Inconel
15	Hex. bolt	A194 B7	A320L7M	A193 B8
16	Nuts	A194 2H	A194 7M	A194 8
17	Seat ring gasket	Graphite / PTFE	Graphite / PTFE	Graphite / PTFE
18	Gasket	Graphite / PTFE	Graphite / PTFE	Graphite / PTFE
19	Stem	A 182-F316	A 182-F316	A 182-F316
20	Lever	Steel	Steel	Steel

Special materials on request.

Specification

Marking	EN19, CE
Face-to-face dimensions	ASME B16.10
Flanged ends, dimensions as per	ASME B16.5
Pressure-Temperature Rating	ASME B16.34
Valve Inspection & Testing	API 598
	AD-2000, EN 12266-2 (DIN 3230 part 3) on request

All of our valves are subject to a steady technological progress and improvement. So details might change without prior notification.